

# MEETING SPACE CAPACITY CHART

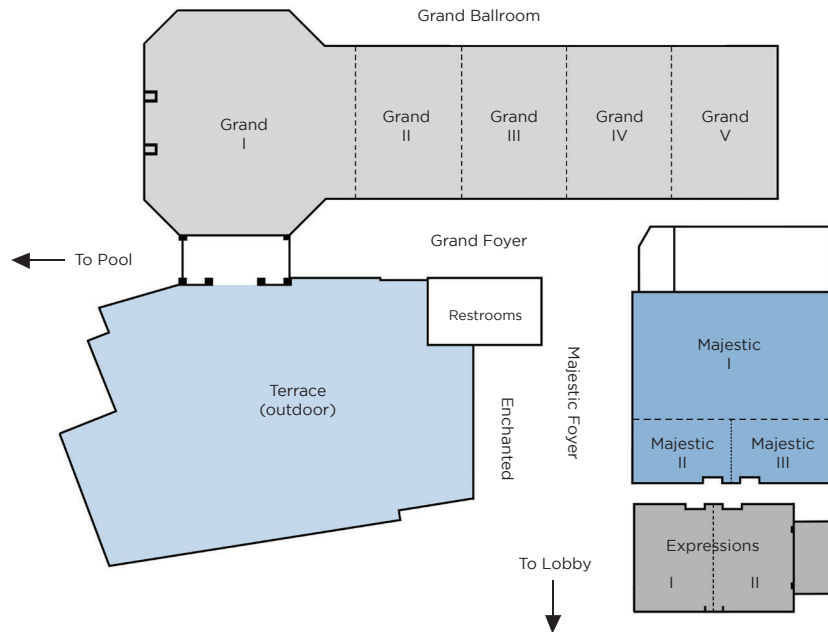

	Dimensions				Number of People											
Room Name	SF	L	W	H	THE	CR	RD8	RD10	CRS6	RECP	CONF	U/S	H/S	EX8	EX10	
Grand Ballroom	10182	192'	70'/32'	20'/12'	1000	500	600	750	360	1000	N/A	N/A	N/A	49	43	
Grand I	4017	64'	70'	20'	400	200	224	280	108	400	54	60	80	16	16	
Grand II	1500	46'	32'	12'	150	75	80	100	48	150	38	44	45	6	6	
Grand III	1500	46'	32'	12'	150	75	80	100	48	150	38	44	45	6	6	
Grand IV	1500	46'	32'	12'	150	75	80	100	48	150	38	44	45	6	6	
Grand V	1500	46'	32'	12'	150	75	80	100	48	150	38	44	45	6	6	
Grand Foyer	2100	100'	21'	12'	N/A	N/A	N/A	N/A	N/A	250	N/A	N/A	N/A	N/A	N/A	
Majestic Ballroom	3900	60'	65'	12'	400	200	200	250	108	400	N/A	60	80	20	16	
Majestic I	2400	60'	40'	12'	250	100	120	150	84	250	48	50	56	12	8	
Majestic II & III	1500	60'	25'	12'	100	50	56	70	30	125	48	40	45	8	4	
Majestic II	750	30'	25'	12'	50	20	24	30	18	60	16	15	20	3	2	
Majestic III	750	30'	25'	12'	50	20	24	30	18	60	16	15	20	3	2	
Majestic Pre-function	2241	72'	31'	12'	N/A	N/A	N/A	N/A	N/A	250	N/A	N/A	N/A	4	3	
Expressions I & II	1617	49'	33'	12'	175	75	80	100	54	175	40	45	50	10	10	
Expressions I	800	24'	33'	12'	80	30	32	40	24	80	24	20	24	3	4	
Expressions II	800	24'	33'	12'	80	30	32	40	24	80	24	20	24	3	4	
Terrace	5312	64'	83'	N/A	400	N/A	360	450	270	600	N/A	N/A	N/A	N/A	N/A	
Enchanted	1152	57' 9"	19' 9"	9'	60	32	48	58	30	60	26	21	24	N/A	N/A	
Relaxation Room	484	20'	21'	7'	45	28	32	30	24	40	20	20	22	N/A	N/A	
B Social	484	20'	21'	7'	45	20	24	20	18	40	20	15	22	N/A	N/A	
B Magical (movie theater)	420	20'	21'	7'	12	N/A	N/A	N/A	N/A	N/A	N/A	N/A	N/A	N/A	N/A	
Inspiration	484	20'	21'	7'	45	20	32	30	18	40	20	20	22	N/A	N/A	
Imagination Room	380	20'	19'	7'	30	15	N/A	N/A	N/A	N/A	14	N/A	N/A	N/A	N/A	
Self-Expression	486	22'	19'	7'	35	20	24	20	24	40	20	18	18	N/A	N/A	
B Artistic	486	22'	19'	7'	35	24	32	30	24	40	20	15	19	N/A	N/A	
Ideas Room	420	20'	21'	7'	45	28	32	30	24	40	22	20	19	N/A	N/A	
Executive Boardroom	264	11'	24'	8'	N/A	N/A	N/A	N/A	N/A	N/A	10	N/A	N/A	N/A	N/A	

Legend: **THE** Theater | **CR** Classroom | **RD** Round Tables | **CRS** Crescent | **RECP** Reception | **CONF** Conference | **U/S** U-Shape | **H/S** Hollow Square | **EX** Exhibit



## RESORT & SPA

DISNEY SPRINGS RESORT AREA

Introducing a lifestyle hotel to the *Disney Springs*® Resort area, B Resort & Spa features 394 newly renovated guest rooms and suites that showcase stylish yet playful decor for the most discerning families and adults.

B Resort & Spa is an *Official Walt Disney World*® Hotel and all groups that host their meetings at our resort have access to training and programs through the *Disney Institute*®.

B Signature Elements and desirable amenities allow guests to create tailored experiences in an open, self-expressive environment where anyone can just B.

B Nourished with creative culinary options.

Whether hosting a small meeting, cocktail reception or grand affair, our meetings and events professionals will be sure to exceed your expectations.

## AT A GLANCE

### GUEST ROOMS:

- 394 Guest Rooms and Suites
- Check-in: 4PM | Check-out: 11AM
- In-room amenities include:
  - 47" HD LED televisions
  - The Blissful Bed® - B Hotels & Resorts' signature bed
  - In-room safe and beverage cooler
  - Bunk beds in select guest rooms

### PARKING & VALET:

Self parking and valet parking is available (fee applies)

### INTERNET:

FreeB Wi-Fi - Complimentary internet access is provided throughout the hotel, including guest rooms

### AMENITIES:

#### B Sun-kissed

Outdoor, heated zero entry pool and pool bar

#### B Nourished®

American Kitchen Bar & Grill, The Pickup (grab & go), The Pool Bar

#### B Magic®

Complimentary shuttle service to the *Walt Disney World*® Theme Parks as well as 30 minute early entry to any Theme Park every morning

#### B Active®

Fitness Center

#### B Humane

Destination-specific endangered species program supporting nonprofit organizations

### MEETING ROOMS AND EVENT SPACE:

25,000 sq. ft. of flexible function space, which includes 5,000 sq. ft. of outdoor event space

### AIRPORT:

Located 13 miles from Orlando International Airport

### TRANSPORTATION:

Taxi to Orlando International Airport: Approximately \$50 each way  
Shuttle to Orlando International Airport: \$40 roundtrip to hotels



HOTELS & RESORTS®